

## COPPER CRIMP LUGS

### APPLICATIONS

- Electrical panels
- Control panels
- Circuit panels
- Switchboards
- Junction boxes
- Bus bar applications
- Mass transit

The TE Connectivity Copper Crimp Lug is a tinned seamless copper tube.

It is available in various sizes ranging from 2.5 mm<sup>2</sup> to 95 mm<sup>2</sup>. Other sizes are available on request.

These Copper Crimp Lugs are suitable for multi-stranded copper conductors.

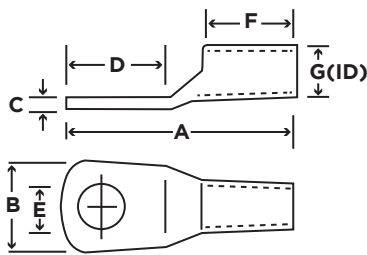

### KEY FEATURES

- All lugs made of tin plated seamless copper tube
- Suitable for copper conductors with wire range of 2.5 - 95 mm<sup>2</sup>
- Other sizes available on request

TE Part Number	Wire Size mm <sup>2</sup>	Stud Size	Dim A	Dim B	Dim C	Dim D	Dim F	Dim G
1-1627722-1	2.5	M4	21.4	9.1	1.1	11.9	8	2.5
2-1661591-0	2.5	M5	21.4	9.1	1.1	11.9	8	2.5
1-1627723-0	2.5	M6	26.2	10.3	0.9	15.1	8.7	2.5
1-1627723-2	2.5	M8	26.2	10.3	0.9	15.1	8.7	2.5
9-1661590-5	4	M5	21	8.7	1.5	11.1	8	3.3
1-1627697-0	4	M5	27.3	8.7	1.5	14.7	9.2	3.3
1-1627698-0	4	M6	27.8	10.3	1.2	15.1	9.5	3.3
1-1627698-2	4	M8	28.6	13	1	13.3	9.5	3.3
2086687-1	6	M5	27	10.3	1.2	15	9.5	3.7
1-1627699-0	6	M6	27	10.3	1.2	15	9.5	3.7
1-1627700-1	6	M8	28.6	13.9	0.9	16.7	9.5	3.7
1-1627700-2	6	M10	28.6	13.9	0.9	16.7	9.5	3.7
1-1627701-4	10	M6	27	11.9	1.8	15.5	9.5	4.7
9-1661590-7	10	M6	29.4	11.9	1.8	15.5	11.5	4.7
1-1627701-0	10	M8	28.6	14.3	1.6	16.3	9.5	4.7
9-1661590-6	10	M10	30.6	14.3	1.6	16.3	9.5	4.7
2086688-1	10	M12	30.6	14.3	1.6	16.3	9.5	4.7
1-1627702-0	16	M6	39.7	11.6	2.3	16.3	20.6	5.5
1-1627703-0	16	M8	39.7	13.5	1.9	16.3	20.6	5.5
1-1627703-1	16	M10	46	17.5	1.4	20.5	20.6	5.5
2086689-1	16	M12	41.5	13.5	1.9	18.5	20.6	5.5
1-1627709-1	25	M6	43.6	13.5	2.2	19	22	7.1
1-1627709-0	25	M8	43.6	13.5	2.2	19	22	7.1
1-1661591-2	25	M10	43.6	16.7	1.9	19	22	7.1
1-1627710-1	25	M12	51	18.2	1.7	25.4	21	7.1
1-1627665-0	35	M6	43.6	16	2.7	19	22.2	8.4
1-1627667-0	35	M8	43.6	16	2.7	19	22.2	8.4
1-1627668-0	35	M10	43.6	18.2	2.7	19	22.2	8.4
1-1627671-0	35	M12	51.2	20	2.2	24.5	22	8.4
2086690-1	50	M6	48	20	2.2	20.8	22	8.4
1-1627711-0	50	M8	48	18.2	3.1	20.8	22.2	9.5
1-1627712-0	50	M10	48	19	3.1	20.8	22.2	9.5
1-1627713-0	50	M12	51.6	20.6	2.8	27	22.2	9.5
1-1627714-4	70	M6	52	20.6	3.2	22	23	11
1-1627714-1	70	M8	54	20.6	3.2	27	23	11
1-1627714-0	70	M10	54	20.6	3.2	27	23	11
1-1661591-6	70	M12	54	20.6	3.2	27	23	11
1-1627715-0	70	M16	54.2	27.5	2.4	27	22	11
2-279464-2	95	M8	56	25.4	4	22	27	13.4
1-1627716-0	95	M10	57.2	25.4	4	27	27	13.4
1-1627717-0	95	M12	57.2	25.4	4	27	27	13.4
2-1661591-1	95	M16	70	27	3.7	37.6	25.4	13.4



Authorised Reseller

CONTACT MAJOR PRODUCT STOCKIST:



Electro-Power and Data Equipment Pty Ltd

Phone 1300 361 003

Phone Intl + 61 3 5374 0980 • Fax +61 3 5374 0989 • Nat 1300 134 416 • Email epde@epde.com.au • Web www.epde.com.au